



LEGAL ADVERTISEMENT INVITATION TO BID

Notice is hereby given, that Big Cypress Housing Corporation will receive sealed bids in response to Solicitation #2018-MSV-01 for the project known as Main Street Village Precast Concrete Wall. This solicitation is for the building permitting, construction and installation of a precast concrete wall. The precast wall shall be installed at Main Street Village located at 104 Anhinga Circle, Immokalee, Florida. Funding for this project is provided by Collier County Division of Community and Human Services using SHIP program funds.

All sealed bids are to be received no later than 2:00 PM, Tuesday, February 27th, 2018 at Main Street Village located at 104 Anhinga Circle, Immokalee, FL 34142. Survey plans and specifications may be obtained by contacting the project representative, Dottie Cook, at 239-658-3315 or email dottiecook@ruralneighborhoods.org. These bids will be opened and recorded on February 27th, 2018 at 2:00 PM.

A non-mandatory pre-bid meeting will be held on Thursday, February 8th, 2018 at 11:00 AM at Main Street Village at 104 Anhinga Circle, Immokalee, FL 34142.

Minority, female-owned and small businesses are encouraged to submit bids for this project. Licensed contractors are encouraged to solicit bids from minority and female-owned subcontractors; effort for such should be documented. A current listing of certified minority and female-owned businesses can be found on the certified Vendor Directory at:

<http://www.dms.myflorida.com/otherprograms/officeofsupplierdiversityosd>

All applicable laws, ordinances and the rules and regulations of all authorities having jurisdiction over construction of this project shall apply to the project throughout.

Big Cypress Housing Corporation complies with the Fair Housing Act (42 U.S.C. 3600 et seq) and County Fair Housing Ordinance 92-9

SPECIFICATIONS

Main Street Village Precast Concrete Wall

Big Cypress Housing Corporation requests sealed written bids for precast concrete wall to be installed at its Main Street Village rental community located at 104 Anhinga Circle, Immokalee, FL 34142. This work includes the following:

- The work consists of providing all labor, equipment, supplies, material, transportation, handling, storage and performing all operations necessary to complete the construction of the precast concrete wall.
- The work also consists of preparing all requisite plans and obtaining all necessary permits including permit fees from Collier County, FL. Survey information shall be provided to the Contractor by Owner
- The installed wall includes two sections: the west installation is 85 LF +/- and the east installation is 615 LF +/- . Total linear feet is estimated at 700 LF.
- The installed wall shall be painted using Sherwin-Williams SuperPaint Exterior Acrylic Latex or equivalent. Paint colors shall match colors and pattern in use on adjacent concrete wall at Immokalee Boys and Girls Club.
- Contractor shall be responsible for the removal and disposal of existing chain link fence (85 LF +/-) and wood fence (615 LF +/-). Note: the latter may be partially damaged due to Hurricane Irma.
- Fence construction specifications are shown in the attached PDF drawing. The attached site plan illustrates the east and west perimeter locations. The contractor shall include an linear foot cost in its bid to be used to adjust final installed length.

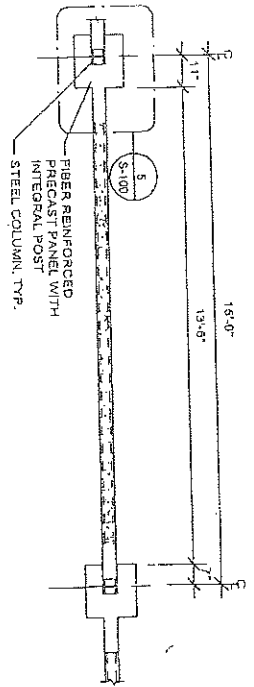

1 PANEL PLAN VIEW
Scale: 1/4" = 1'-0"

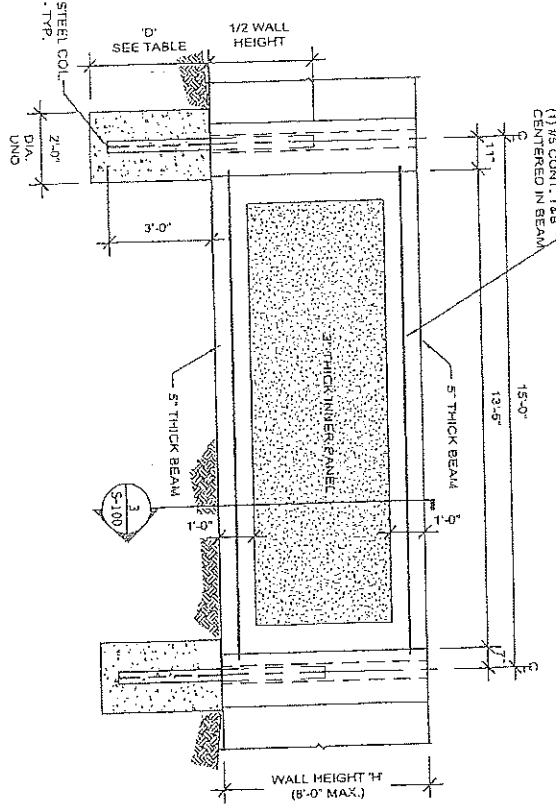

2 PANEL ELEVATION
Scale: 1/4" = 1'-0"

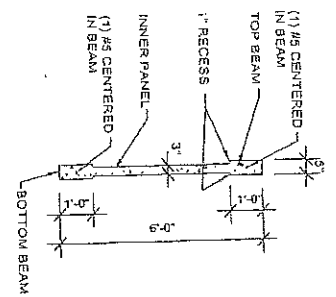

3 WALL PANEL SECTION
Scale: 1/4" = 1'-0"

WIND SPEED	EXPOSURE	'H' = 6'	'H' = 8'	EMBEDMENT DEPTH 'D' FOR 24" DIA CONC	FOUNDATION DIA FOR 6' HIGH WALL AND 3'-6" EMBEDMENT 'D'
160 MPH	B	4'-0"	5'-6"	40" DIA	
160 MPH	C	4'-6"	6'-0"	61" DIA	
170 MPH	B	4'-3"	5'-9"	48" DIA	
170 MPH	C	5'-3"	6'-6"	68" DIA	

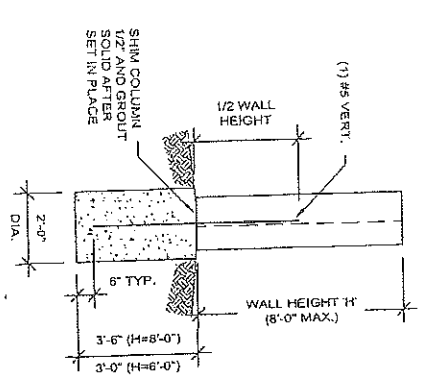

4 STAND ALONE COLUMN
Scale: 1/4" = 1'-0"

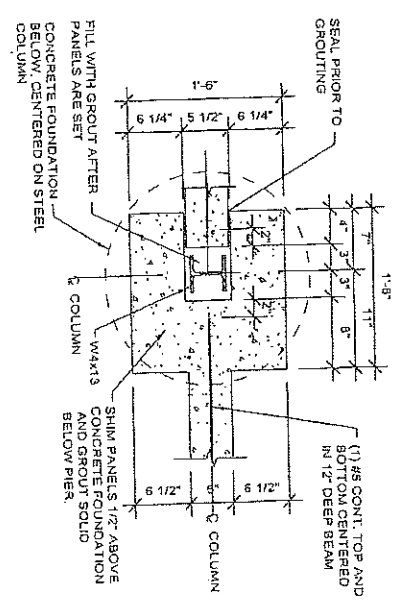

5 PLAN VIEW AT PIER
Scale: 3/4" = 1'-0"

General Notes:

- 1) Design was based on 2014 Florida Building Code.
- Wind Speed: See foundation depth table
- Exposure: See foundation depth table
- Risk Category: 1
- Assumed Soil Properties: 2,000 psf
- Allowable Bearing Pressure: 500 psf
- Allowable Passive Soil Pressure:
- Material Properties:
- Fiber Reinf. Precast Panel: $f_c = 5,000$ psi
- Concrete: $f_c = 3,000$ psi
- Steel Reinforcing: $F_y = 60,000$ psi ASTM A-615
- Structural Steel: $F_y = 50$ ksi ASTM A-992
- Grout: $f_c = 3,000$ psi
- 2) Contractor shall field verify all dimensions and notify engineer of any discrepancies.

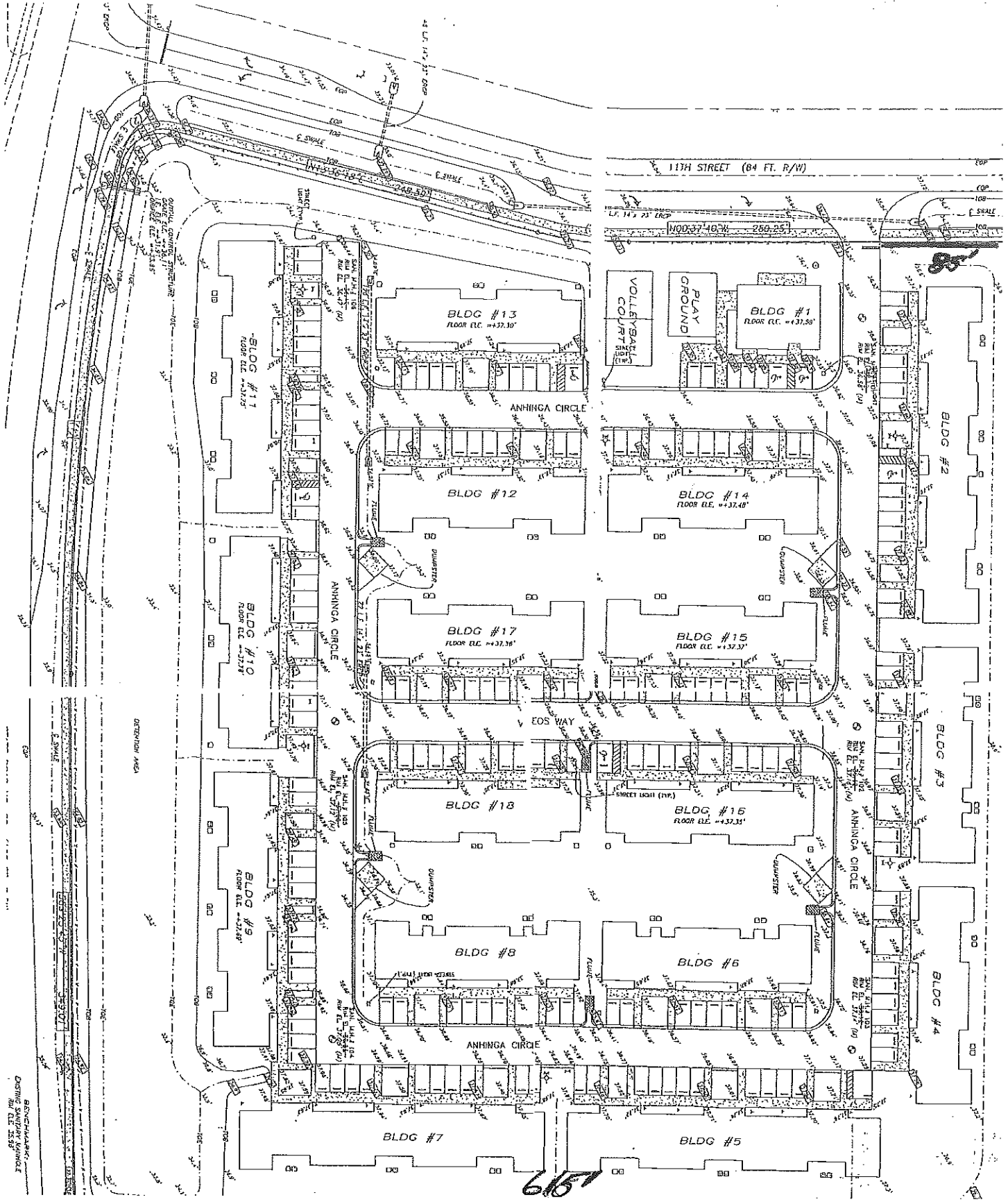

BLDG #11
FLOOR E.L. = +37.30'

BLDG #13
FLOOR E.L. = +37.30'

BLDG #1
FLOOR E.L. = +37.50'

BLDG #12

BLDG #14
FLOOR E.L. = +37.48'

BLDG #10
FLOOR E.L. = +37.28'

BLDG #17
FLOOR E.L. = +37.36'

BLDG #15
FLOOR E.L. = +37.37'

BLDG #18

BLDG #15
FLOOR E.L. = +37.31'

BLDG #9
FLOOR E.L. = +37.18'

BLDG #8

BLDG #6

BLDG #7

BLDG #5

11TH STREET (84 FT. R/W)

ANHINGA CIRCLE

ANHINGA CIRCLE

ANHINGA CIRCLE

ANHINGA CIRCLE

EOS WAY

VOLLEYBALL COURT

PLAY GROUND

LANDSCAPING
DRAWING NUMBER: 1000
DATE: 12.28.87

615

BID FORM
Main Street Village Precast Concrete Wall Installation

Name of Contractor: _____

Address:

Telephone: _____
Email: _____

Base Bid: providing all permitting, labor, equipment, supplies, material, transportation, handling, storage and performing all operations necessary to remove existing chain link and wood fence and complete the construction of the 700 LF +/- of painted precast concrete wall as described in specifications and drawings.

\$ _____

Add/Deductive Itemized Cost:

\$ _____ per LF

Signature of Authorized Representative

Date: _____